

Chalet Hotham 17

17/1 Lawlers Court, Hotham Heights, VIC. 3741



MT HOTHAM
ACCOMMODATION



FEATURES:



4 Occupancy



1 Bedroom



1 Bathroom



Dish Washer



WIFI Internet

ABOUT THIS PROPERTY

Chalet Hotham has been a landmark at Mount Hotham for many years. It is sited in one of the best locations available offering unsurpassed views. This development has been planned and undertaken to provide the very best in on snow accommodation. The apartments have been designed to include all modern appliances and fittings.

Check-In: After 4pm **Check-out:** Before 10am.

Over Snow: 1 trip IN and 1 trip OUT included to assist with your luggage.

[Click Here To See Mt Hotham Village Directory](#)

KITCHEN & COOKING FACILITIES

Full Kitchen - Oven, Microwave, Dishwasher, Bar Size Fridge

BEDROOMS & BEDDING CONFIGURATION

Bedroom: 1 x Queen Bed

Lounge: 1 x Double Fold Out Sofa

BATHROOMS

1 x Bathroom with Heated towel Rails, Spa bath & Bathroom Amenities

HEATING & COOLING FACILITIES

- Gas Log Fire
- Hydronic heating

LAUNDRY DETAILS

Guest Laundry - Coin Operated

ENTERTAINMENT FACILITIES

TV, DVD Player, Sound System

EXTRA FACILITIES

- Wifi
- Private Ski locker
- Personal Drying Cupboard

PARKING

Hotham overnight car parking - **Resort Entry will need to be purchased**

Chalet Hotham 17

17/1 Lawlers Court, Hotham Heights, VIC. 3741



SMOKING

This is a Non-Smoking Apartment

Chalet Hotham, Apartment 17

17/1 Lawlers Court, Mount Hotham

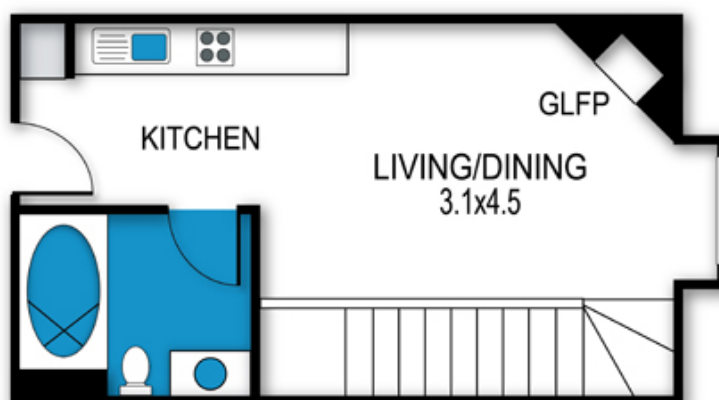

LOWER LEVEL

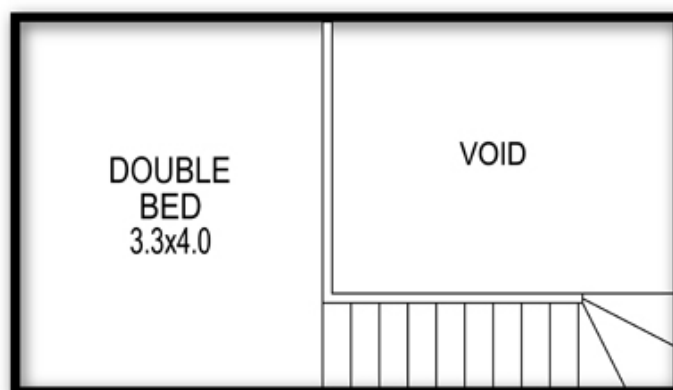

UPPER LEVEL

archistyle

Whilst every attempt has been made to ensure the accuracy of this floorplan, measurements of doors, windows, rooms and any other items are approximate only. The producer or the agent cannot be held responsible for any errors, omissions or misstatements. This plan is for illustrative purposes only and should be used as such.

Chalet Hotham 17

17/1 Lawlers Court, Hotham Heights, VIC. 3741



MT HOTHAM
ACCOMMODATION

