

Lawlers 4

4/Building 1 - Alfonso Walk, Hotham Heights, VIC. 3741



FEATURES:



14 Occupancy



4 Bedroom



3 Bathroom



1 Car Parking



Dish Washer



Washing Machine

ABOUT THIS PROPERTY

Lawlers apartments have been a long-standing favourite with groups and families for many years due to their proximity to the centre of the Hotham Village, chair lifts, shuttle bus, restaurants and bars that Hotham has to offer. Lawlers 4 is a three-level, four-bedroom, three-bathroom apartment with great views. This well-presented apartment has a wonderful feel and you can understand why so many people keep coming back to Lawlers 4. This apartment also includes one car space in Lawler's car park. **Resort access permits are still required through Alpine Easy Access for the duration of your stay.** The views from this side of Mt Hotham are fantastic, you can enjoy apres on your very own balcony and watch the sun going down after a long day on the slopes. Perfect!

Check-In: After 4pm **Check-out:** Before 10am

Over Snow: 2 trips IN and 2 trips OUT included to assist with your luggage.

[Click Here To See Mt Hotham Village Directory](#)

KITCHEN & COOKING FACILITIES

Full Kitchen - Oven, Cook Top, Dishwasher, Microwave, Full Size Fridge

BEDROOMS & BEDDING CONFIGURATION

Bedroom 1: 1 x Queen Bed & 1x Single Bunk Bed

Bedroom 2: 1 x Queen Bed & 1x Single Bed

Bedroom 3: 1 x Queen Bed

Bedroom 4: 1 x Trilogy Bunk Bed & 1 x Single Bunk Bed

BATHROOMS

3 x Bathrooms

HEATING & COOLING FACILITIES

Central & gas log fire

LAUNDRY DETAILS

- Washing Machine
- Dryer

ENTERTAINMENT FACILITIES

LCD TV, DVD Player, Sound System

EXTRA FACILITIES

Drying Cupboard



PARKING

1 x Lawlers overnight car park - **Resort Entry will need to be purchased**

SMOKING

This is a Non-Smoking Apartment

Lawlers Apartments, Apartment 4

4_2 Lawlers Court, Mt Hotham

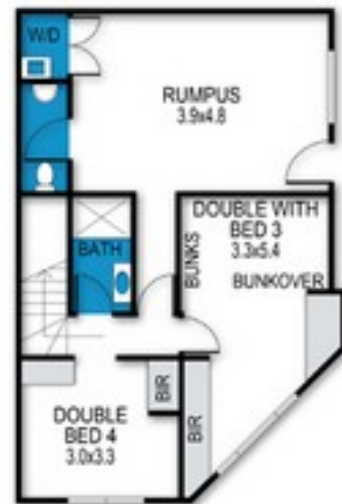

archistyle

Whilst every attempt has been made to ensure the accuracy of this floorplan, measurements of doors, windows, rooms and any other items are approximate only. The producer or the agent cannot be held responsible for any errors, omissions or misstatements. This plan is for illustrative purposes only and should be used as such.

Lawlers 4

4/Building 1 - Alfonso Walk, Hotham Heights, VIC. 3741



MT HOTHAM
ACCOMMODATION

