



## FEATURES:

---



4 Occupancy



1 Bedroom



1 Bathroom



1 Car Parking



Washing Machine

## ABOUT THIS PROPERTY

---

Lawlers apartments have been a long-standing favourite with groups and families for many years due to their proximity to the centre of the Hotham Village, chair lifts, shuttle bus, restaurants and bars that Hotham has to offer. Lawlers 28 is popular with small families as this complex allows guests to play in the snow just adjacent to the entrance. There is also one car space in Lawlers car park for your convenience. **Resort access permits are still required through Alpine Easy Access for the duration of your stay.**

**Check-In:** After 4pm **Check-out:** Before 10am.

**Over Snow:** 1 trip IN and 1 trips OUT included to assist with your luggage.

[Click Here To See Mt Hotham Village Directory](#)

## KITCHEN & COOKING FACILITIES

---

Full Kitchen - Oven, Microwave, Dishwasher, Full Size Fridge, Nespresso coffee machine ( pods not supplied )

## BEDROOMS & BEDDING CONFIGURATION

---

Bedroom: 1 x Queen & 1 x Bunk Bed

## BATHROOMS

---

1 x Bathroom

## HEATING & COOLING FACILITIES

---

Hydronic Heating

## LAUNDRY DETAILS

---

- Washing Machine
- Dryer

## ENTERTAINMENT FACILITIES

---

65" Smart TV, DVD Player, Sound System,

## EXTRA FACILITIES

---

Personal Drying cupboard

## PARKING

---

1 x Lawlers overnight car park - **Resort Entry will need to be purchased**

## SMOKING

---

This is a Non-Smoking Apartment



## Lawlers Apartments, Apartment 28

28\_2 Lawlers Court, Mt Hotham



MT HOTHAM  
ACCOMMODATION

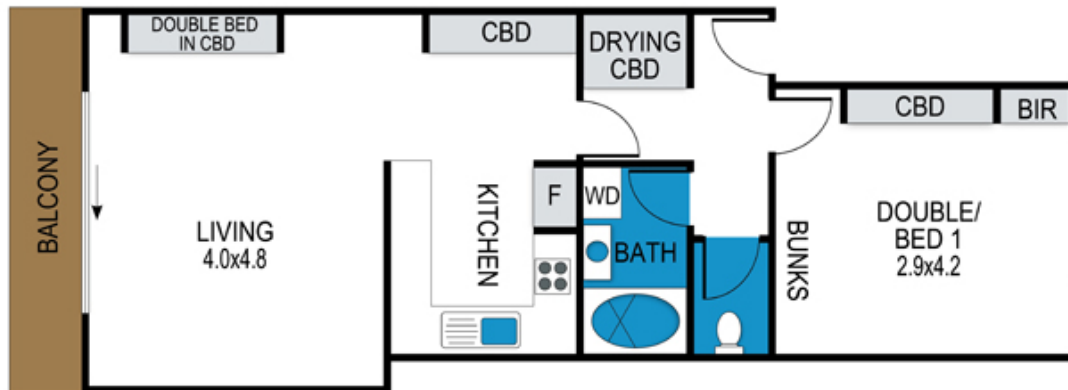

archistyle

Whilst every attempt has been made to ensure the accuracy of this floorplan, measurements of doors, windows, rooms and any other items are approximate only. The producer or the agent cannot be held responsible for any errors, omissions or misstatements. This plan is for illustrative purposes only and should be used as such.

# Lawlers 28

28/Building 4 - Alfonso Walk, Hotham Heights, VIC. 3741



MT HOTHAM  
ACCOMMODATION

