

# Alpine Haven 7

7/13 Higgi Drive, Hotham Heights, VIC. 3741



## FEATURES:



2 Occupancy



1 Bedroom



1 Bathroom



Strict NO Party Policy



Strict NO Pets Accepted



DVD Player



Kitchenette



Linen Included



Microwave

## ABOUT THIS PROPERTY

---

Alpine Haven Apartments are positioned right next to the Arlberg complex, This cozy bedsit apartment is ideal for couples to enjoy their own private facilities, yet being close enough to all the action, with just a short walk to Hotham Central, you will be in prime position for your next Winter Holiday.

**Check-In:** After 4pm **Check-out:** Before 10am

**Over Snow:** 1 trip IN and 1 trip OUT included to assist with your luggage.

[Click Here To See Mt Hotham Village Directory](#)

## KITCHEN & COOKING FACILITIES

---

Kitchenette - Oven, Microwave, Bar size Fridge, Kettle, Toaster.

## BEDROOMS & BEDDING CONFIGURATION

---

Studio: 1x Double bed

## BATHROOMS

---

1 x Bathroom

## HEATING & COOLING FACILITIES

---

Electric Panel Heating

## LAUNDRY DETAILS

---

Guest Laundry - Coin Operated

## ENTERTAINMENT FACILITIES

---

TV, DVD Player

## EXTRA FACILITIES

---

Ski lockers at entry

## PARKING

---

Hotham overnight car parking - **Resort Entry will need to be purchased**

## SMOKING

---

This is a Non-smoking apartment

# Alpine Haven 7

7/13 Higgi Drive, Hotham Heights, VIC. 3741



## Alpine Haven, Apartment 7

7\_13 Higgi Drive, Mt Hotham

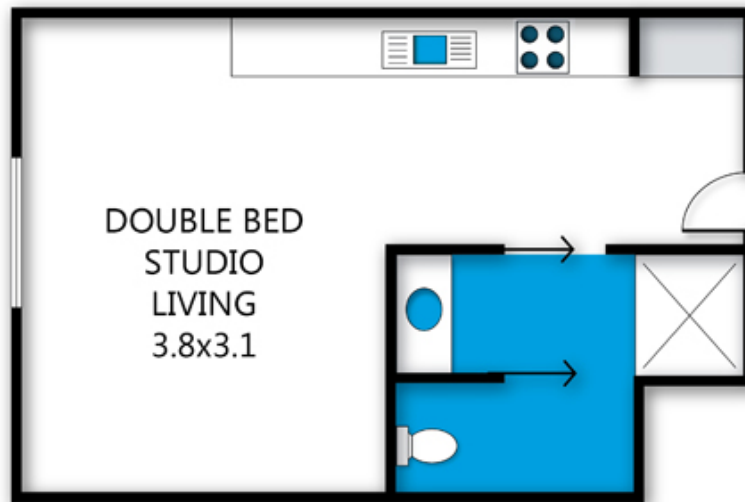

archistyle

Whilst every attempt has been made to ensure the accuracy of this floorplan, measurements of doors, windows, rooms and any other items are approximate only. The producer or the agent cannot be held responsible for any errors, omissions or misstatements. This plan is for illustrative purposes only and should be used as such.

# Alpine Haven 7

7/13 Higgi Drive, Hotham Heights, VIC. 3741



MT HOTHAM  
ACCOMMODATION

